

Over-dimensioning: the same feature is located more than once.

- Causes confusion on how to make a part; parts can be made in more than one way.
- "Identical" parts made by using different measurements (even if made by the same person) will not be exactly the same.

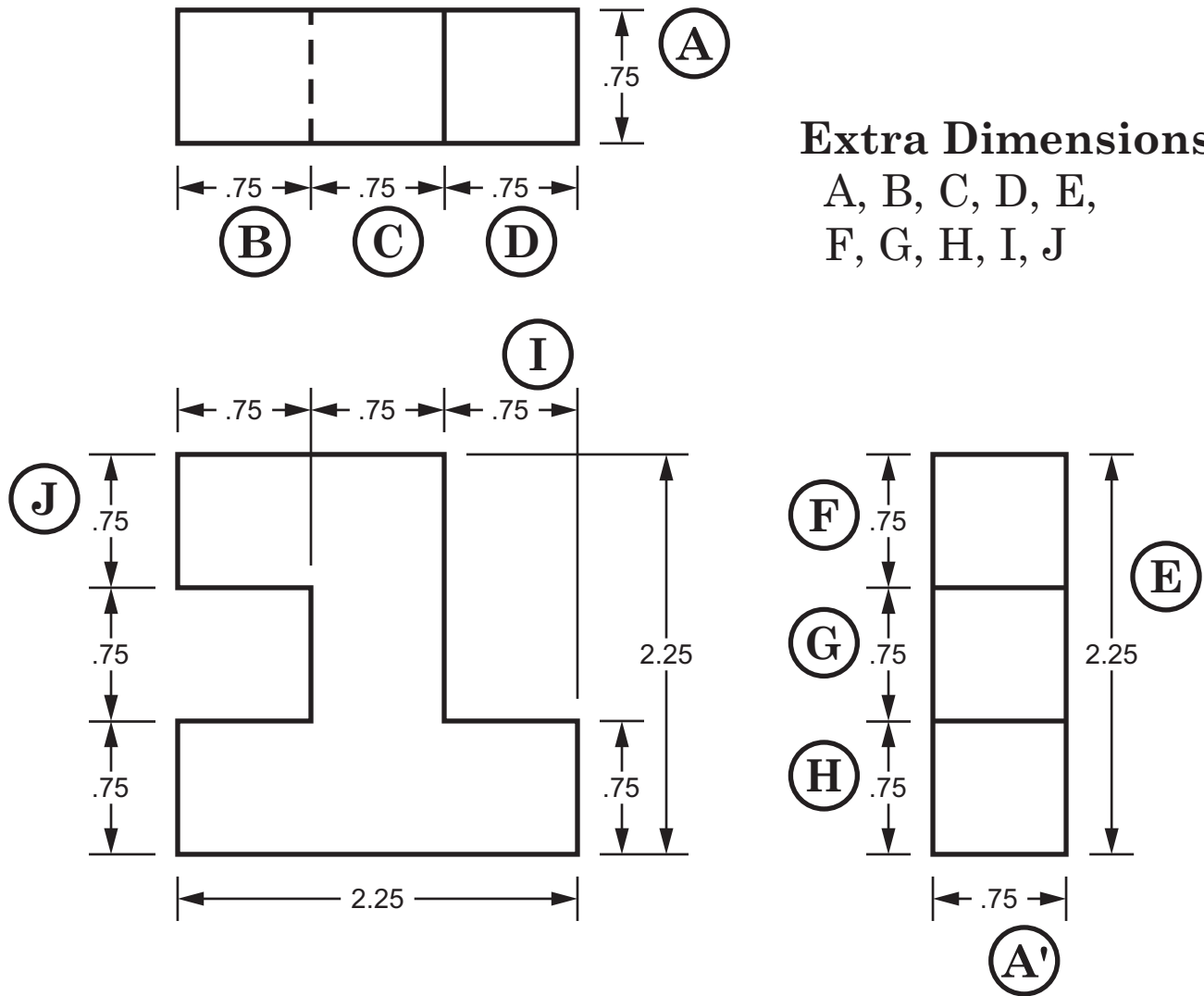

Extra Dimensions:
 A, B, C, D, E,
 F, G, H, I, J

- A. Already dimensioned at bottom of **Right View** (A').
- B, C, D. Already dimensioned in **Front View**.
- E. Already dimensioned at right in **Front View**.
- F, G, H. Already dimensioned in **Front View**.
- I. The width of part is 2.25", already dimensioned at bottom of **Front View**.
 The 0.75" labeled I locates the right side of the part again.
 In practice, if one person makes the part 3x0.75" wide, and second person (or the same person) makes the part 2.25" wide, the two parts will not be exactly the same width. In practice, 3x0.75" ≠ 2.25".
- J. The height of the part is 2.25", given at the right of the **Front View**.
 The 0.75" labeled J locates the top of the part again (see I).

Under-dimensioning: not all features are located.

- Parts will not all be made to the same dimensions.

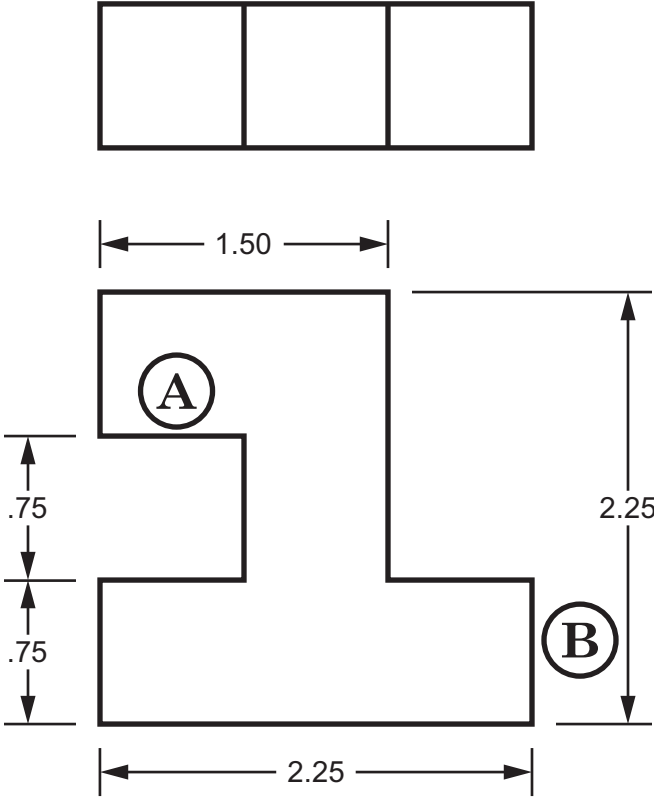

Missing Dimensions:
A, B, C



- A. The depth of the notch is not indicated
- B. The height of the right step is not indicated. It looks like it is 0.75" above the bottom (like the left step), but do not make that assumption.
- C. The thickness (depth) of the part is not indicated.

The following part(s) would satisfy the dimensions, or lack of dimensions (A, B and C), given above.

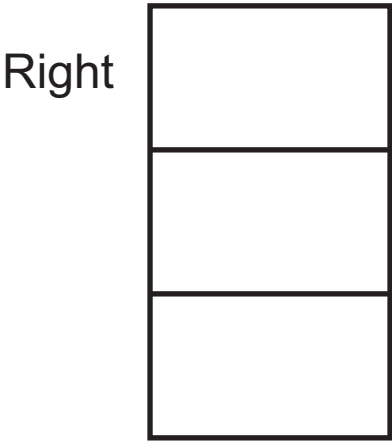
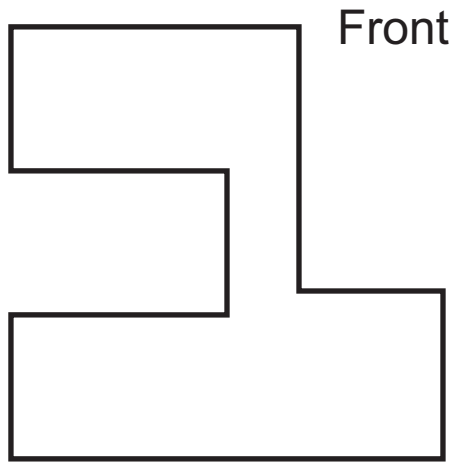

JUST RIGHT: each feature is located only once.

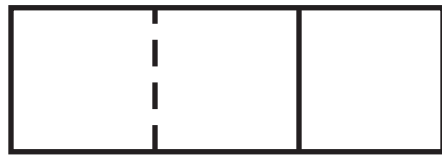

TOP VIEW: In this case, no dimensions are needed on the Top View. All features are already dimensioned in the Front and Right Views.

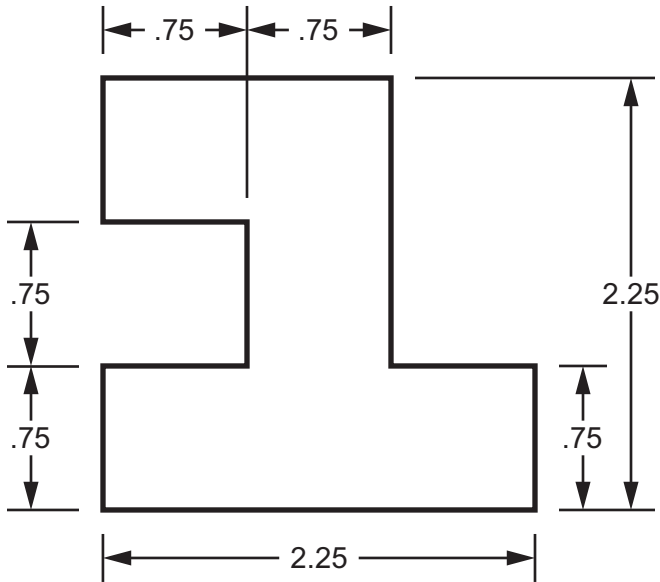

REMINDER: DIMENSION LINES have arrowheads at each end.

Correct

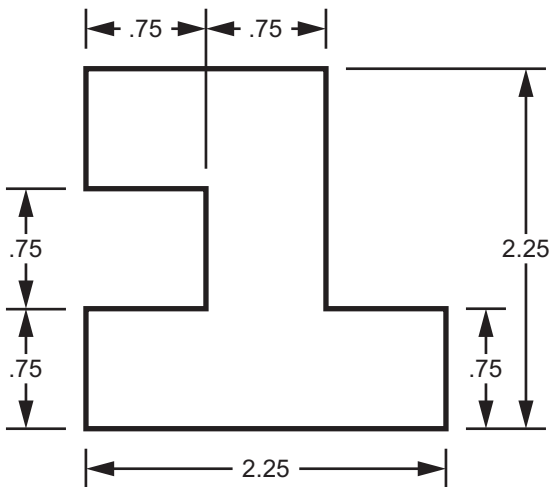

Incorrect

